

Sports and Recreation

The region offers innumerable possibilities.
Just a few ideas:

- Breakfast in the mountains
- Fondue party and night skiing with torches
- Eventful evening in a mountain chalet
- Milking goats and specially aperitif
- Visit to a cheese cellar

And a few more ideas are awaiting you ...



Partners in Adventure

We recommend you our local partners.



arc-en-ciel
HOTEL · GSTAAD

Seminar and conference packages

2008/2009	Half-board	Full board
January March to June September to December	Fr. 229.-	Fr. 267.-
Other dates	prices on request	prices on request

Package prices as from 10 guests are per day and person in single room with bath or shower and balcony, cable-TV, radio, minibar, safe, direct-dial telephone, internet-connection and hair dryer.
Prices including service, tax and VAT.

Breakfast buffet, business-lunch (dinner by full-board), 2 coffee-breaks, mineral water, conference room with flip-chart, overhead projector and screen.

Public Wireless LAN im ganzen Haus



Room	m ²	Capacity				
		Concert	Bloc	Parliament	U-Form	Banquet
Ganzer Raum	95,5	100 pers.	50 pers.	50 pers.	30 pers.	80 pers.
Eggli and Wassergrat	57,0	50 pers.	30 pers.	30 pers.	20 pers.	40 pers.
Eggli	30,0	25 pers.	18 pers.	18 pers.	16 pers.	18 pers.
Wassergrat	27,0	20 pers.	12 pers.	12 pers.	12 pers.	12 pers.
Rellerli	24,0	18 pers.	10 pers.	10 pers.	-	-

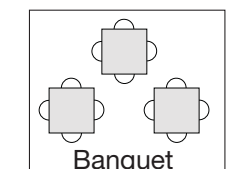
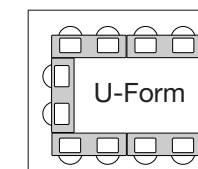
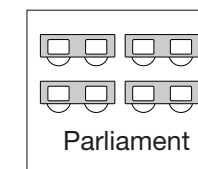
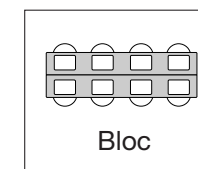
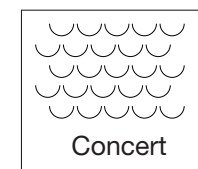

GSTAAD®
COME UP - SLOW DOWN

Hotel Arc-en-ciel

Family Matti
CH-3780 Gstaad
Tel. +41 (0)33 748 43 43 · Fax +41 (0)33 748 43 53
www.arc-en-ciel.ch · info@arc-en-ciel.ch
seminare@arc-en-ciel.ch

www.typodruck.com



Seminar and conference room

Room	Size	Height	Half-day price	Full-day price
Eggli	30 m ²	2,30 m	Fr. 60.–	Fr. 115.–
Wassergrat	27 m ²	2,30 m	Fr. 60.–	Fr. 115.–
Eggli/Wassergrat (together)	57 m ²	2,30 m	Fr. 120.–	Fr. 230.–
Eggli, Wispile, Wassergrat (together)	95 m ²	2,30 m	Fr. 170.–	Fr. 330.–

Room	Size	Height	Half-day price	Full-day price
Ecurie (10 to 15 pers.)	15 m ²	2,50 m	Fr. 40.–	Fr. 70.–
Attika (5 to 12 pers.)	15 m ²	2,50 m	Fr. 40.–	Fr. 70.–
Rellerli (5 to 10 pers.)	24 m ²	2,30 m	Fr. 40.–	Fr. 70.–

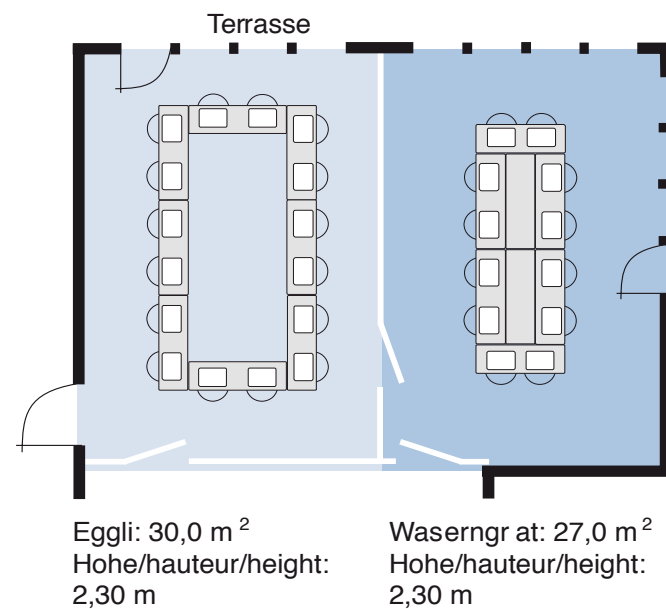
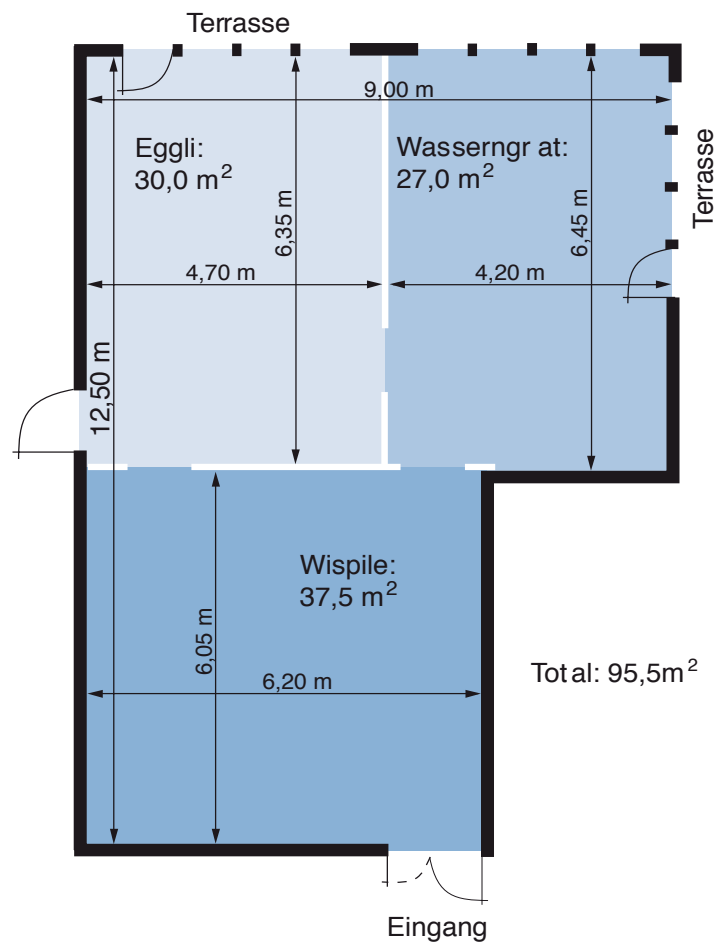

Daily package

Fr. 75.– per person/day

Including:
 Conference room, mineral water,
 two coffee-breaks and business-lunch.
 Service and VAT.

Businesslunch Fr. 32.– per person

Light 3 course menu with a vegetarian choice.

Dinner Fr. 38.– per person

Delicious 3 or 4 course menu specially created by the chef.



The breaks

Some original ideas of how a coffee-break can be served as buffet at the bar or the terrace:

Traditional coffee-break

Coffee or tea, orange juice and crescent-roll Fr. 8.–

Juice-break, something different...

Fresh fruits or vegetable juices, with wholemeal cookies Fr. 8.–

Vegetable-break, really healthy...

Orange juice, several vegetables with «dips» Fr. 8.–

Cheese-break, something spicy...

Cow power, mineral water, «Hobel» cheese and wholemeal bread Fr. 13.–



Terms of payment

By confirmation of the seminar, 50% of the confirmed amount is to be transferred on the account of the Hotel Arc-en-ciel. UBS AG Gstaad 227-256071.12C. The remaining sum shall be paid no later than 10 days after receiving the bill.

Cancellation policy

4 weeks prior to arrival: no cost. From 4 to 3 weeks prior to arrival: 30%. From 3 to 2 weeks prior to arrival: 50%. From 2 to 1 week prior to arrival: 80% of daily package price per person.